

MATERIAL	NON-ALLOYED STEELS ALLOY STEELS TOOL STEELS				ALLOY STEELS, HEAT RESISTANT STEELS				STAINLESS STEELS			
HARDNESS	~ H Rc 30				H Rc 30 ~ H Rc 45							
STRENGTH	~1000N/mm ²				1000~1500N/mm ²							
DIAMETER	RPM	FEED	Vc	fz	RPM	FEED	Vc	fz	RPM	FEED	Vc	fz
1.0	14300	75	45	0.002	8500	45	25	0.002	7150	35	20	0.002
1.5	12750	105	60	0.003	5550	60	25	0.004	5600	55	25	0.003
2.0	7850	110	50	0.005	5150	70	30	0.005	4300	55	25	0.004
3.0	6100	125	55	0.007	3800	85	35	0.007	3150	70	30	0.007
4.0	5150	180	65	0.012	3150	110	40	0.012	2650	90	35	0.011
5.0	4300	190	70	0.015	2550	110	40	0.014	2150	95	35	0.015
6.0	3800	210	70	0.018	2300	135	45	0.020	1950	110	35	0.019
8.0	2850	230	70	0.027	1700	120	45	0.024	1450	110	35	0.025
10.0	2200	195	70	0.030	1350	95	40	0.023	1150	95	35	0.028
12.0	1850	170	70	0.031	1150	75	45	0.022	950	75	35	0.026
14.0	1700	150	75	0.029	1050	70	45	0.022	850	70	35	0.027
16.0	1500	130	75	0.029	950	65	50	0.023	700	65	35	0.031
20.0	1150	100	70	0.029	700	50	45	0.024	550	50	35	0.030

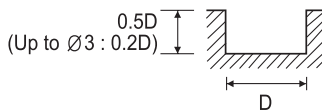

MATERIAL	CAST IRON				ALUMINUM ALLOYS				COPPER, BRASS NON-FERROUS METALS			
HARDNESS												
STRENGTH												
DIAMETER	RPM	FEED	Vc	fz	RPM	FEED	Vc	fz	RPM	FEED	Vc	fz
1.0	18700	185	60	0.003	44000	300	140	0.002	24700	180	80	0.002
1.5	12100	185	55	0.005	27500	345	130	0.004	20300	270	95	0.004
2.0	9350	200	60	0.007	22000	420	140	0.006	16500	310	105	0.006
3.0	6050	200	55	0.011	15400	430	145	0.009	11000	310	105	0.009
4.0	4600	185	60	0.013	11000	420	140	0.013	8800	310	110	0.012
5.0	3650	200	55	0.018	9150	420	145	0.015	6800	310	105	0.015
6.0	2950	230	55	0.026	7600	440	145	0.019	5700	340	105	0.020
8.0	2200	240	55	0.036	5700	440	145	0.026	4400	330	110	0.025
10.0	1850	255	60	0.046	4600	440	145	0.032	3400	330	105	0.032
12.0	1450	275	55	0.063	3750	430	140	0.038	2850	330	105	0.039
14.0	1300	285	55	0.073	3300	430	145	0.043	2400	330	105	0.046
16.0	1100	285	55	0.086	2850	430	145	0.050	2200	330	110	0.050
20.0	900	310	55	0.115	2200	430	140	0.065	1700	330	105	0.065

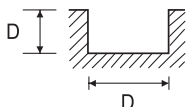

※ The FEED, in long & extra long types, should be reduced by around 50%

RPM = rev./min.
FEED = mm/min.
Vc = m/min.
fz = mm/t