

# KINTEK®

COMPONENTI INNOVATIVI TECNOMECCANICI

# GREAT ACCURACY HIGH PRECISION LINE

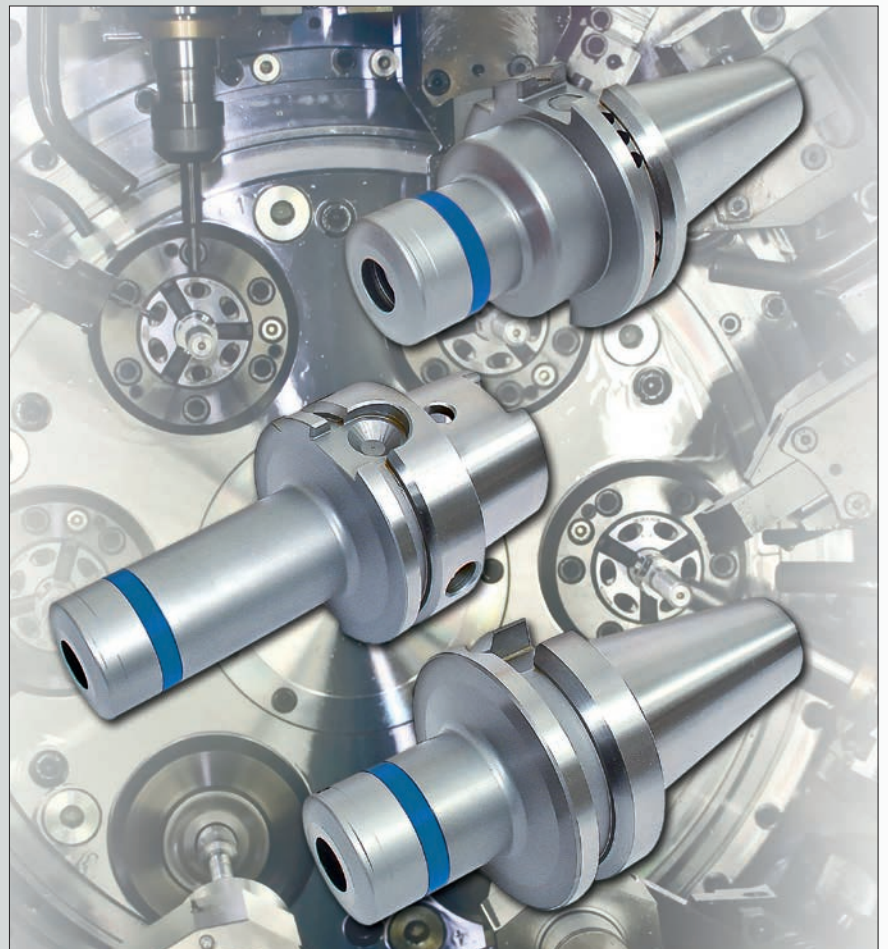

# GREAT ACCURACY - HIGH PRECISION LINE



• **RUN OUT 5 MICRON at 2,5 times the diameter achieved only by using HP ER collets.**

- The High level of accuracy is achieved either on the NOMINAL DIAMETER or by clamping the tool whose diameter is maximum 0,5 mm smaller than the nominal diameter.
  - 20% higher clamping force (compared to standard ER collet chuck system).
  - Not to use with VG /ERC (watertight / Steel sealed) collets.
- Nut for sealing discs available**, to use central coolant and high pressure.



• **RUN OUT 5 MICRON a 2,5 il diametro garantito esclusivamente tramite pinze ER PRECISE.**

- L'elevata precisione si ottiene o sul DIAMETRO NOMINALE o chiudendo l'utensile con diametro al massimo di 0,5mm inferiore al diametro nominale.
  - Forza di serraggio maggiore del 20% (rispetto a portapinza ER standard).
  - Non utilizzare con pinze VG /ERC (tenuta stagna/tenuta stagna meccanica).
- Disponibile anche ghiera con dischi per passaggio interno del lubrificante** ad alta pressione.



• **5 MICRON RUNDLAUFGENAUIGKEIT bei 2,5 Mal des Durchmessers nur durch Verwendung von HP-ER Spannzangen erreicht.**

- Das Erreichen der hohen Genauigkeit erfolgt entweder am NENNDURCHMESSER oder durch das Spannen des Werkzeuges, wessen Durchmesser maximal 0,5 mm kleiner als der Nenndurchmesser ist.
  - 20% höhere Spannkraft (im Vergleich zum Standard ER Spannzagenfuttersystem)
  - Nicht mit VG/ERC (abgedichtete) Spannzangen zu verwenden.
- Mutter für Dichtscheiben verfügbar**, zur Verwendung von Innenkühlung mit hohem Druck



• **COAXIALITE 5 MICRON à 2,5 fois le diamètre obtenu uniquement en utilisant des pinces ER PRECISE.**

- Le haut niveau de précision est obtenu soit sur le NOMINAL DIAMETER soit en serrant l'outil dont le diamètre est au maximum 0,5 mm inférieur au diamètre nominal.
  - Force de serrage 20% supérieure si comparée au system de porte-pince standard
  - Ne pas utiliser ave pince étanche VG/ERC.
- Ecrou pour disque étanche disponible**, pour obtenir l'arrosage central à haute pression.



• **RUN OUT с 5 до 2,5 MICRON достигается только при использовании цанг PRECISION ER .**

- Высокий уровень точности достигается либо при зажиме НОМИНАЛЬНОГО ДИАМЕТРА, либо путем зажима инструмента, диаметр которого не должен превышать 0,5мм номинального диаметра.
  - Сила зажима на 20% выше по сравнению со стандартными цанговыми патронами
  - Не использовать с цангами VG /ERC (водонепроницаемые / механически уплотненные)
- Доступна также гайка с центральным пазом** сож и высоким давлением.



• **使用HP的弹簧筒夹，在2.5倍径的地方刀柄跳动达到5µ。**

- 所夹持的刀具需满足标称直径或比标称直径小0.5mm以内才能达到这个精度。
- 比标准的弹簧刀柄系统高20%的夹持力。
- 密封圈螺帽，适用于中心出水 and 高压

DOUBLE CONTACT ER COLLET CHUCK  
 DOPPELKONTAKT AUFNAHMEN ER SPANNZANGENFUTTER  
 ЦАНГОВЫЙ ПАТРОН ER С ДВОЙНЫМ КОНТАКТОМ  
 ER双向夹头

MAS BT AD+B DOPPIO CONTATTO - DIN 6499

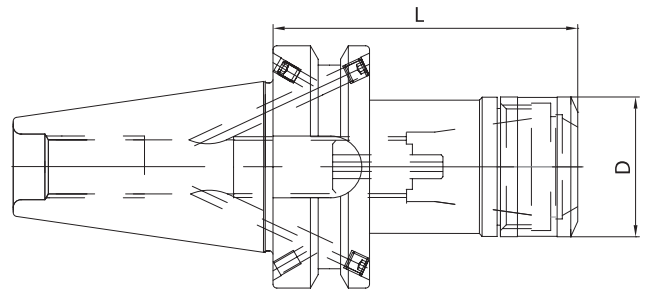
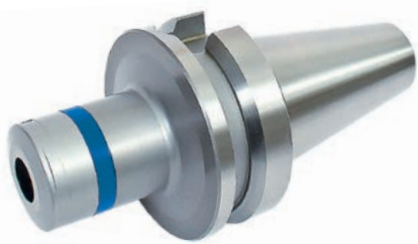

DOUBLE CONTACT

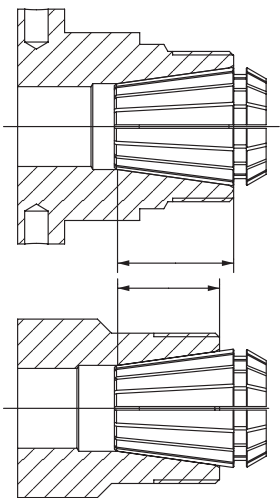

HIGH PRECISION LINE

STANDARD

	CODE N.	DESCRIPTION	ISO	L	D	ER	G2,5 30000
ISO 30	214-37231*	BT30H70ER16-HPDK	30	70	30	16	•
	214-37232*	BT30H70ER25-HPDK	30	70	40	25	•
	214-37233*	BT30H70ER32-HPDK	30	70	50	32	•
ISO 40	214-37219	BT40H70ER16-HPDK	40	70	30	16	•
	214-37220	BT40H70ER25-HPDK	40	70	40	25	•
	214-37221	BT40H70ER32-HPDK	40	70	50	32	•
ISO 40	214-37222	BT40H100ER16-HPDK	40	100	30	16	•
	214-37223	BT40H100ER25-HPDK	40	100	40	25	•
	214-37224	BT40H100ER32-HPDK	40	100	50	32	•
ISO 50	214-37225	BT50H80ER16-HPDK	50	80	30	16	•
	214-37226	BT50H80ER25-HPDK	50	80	40	25	•
	214-37227	BT50H80ER32-HPDK	50	80	50	32	•
ISO 50	214-37228	BT50H100ER16-HPDK	50	100	30	16	•
	214-37229	BT50H100ER25-HPDK	50	100	40	25	•
	214-37230	BT50H100ER32-HPDK	50	100	50	32	•

- \* BT30 only AD version
- \* BT30 solo versione AD
- \* BT30 nur AD Ausführung
- \* BT30 seulement Version AD
- \* BT30 только с AD исполнением
- \* BT30 只在 AD 版本下

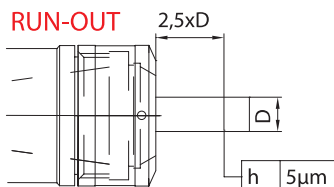

Accessories  
 Accessori  
 Zubehör  
 Accessoires  
 Принадлежности  
 零件

pag. 166 cat. pag. 166 cat.

COLLETS ER TYPE  
 ER TYP SPANNZANGEN  
 НАБОРЫ ЦАНГ ER  
 PINZE TIPO ER  
 PINCES TYPE ER  
 ER 类型的夹头

CODE N.	D	L	ER
812-203085	30	18	16
812-203086	40	20,5	25
812-203087	50	23,5	32

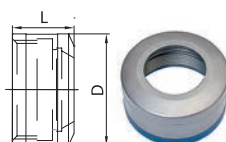

WRENCHES FOR NUT  
 SPANNSCHLÜSSEL FÜR SPANNMUTTER  
 КЛЮЧИ ДЛЯ СТАНДАРНЫХ ГАЕК  
 CHIAVI PER GHIERA  
 CLES DE SERRAGE POUR ECROU  
 标准螺母用扳手

CODE N.	D	D1	ER
816-203069	30	3	16
816-203070	40	4	25
816-203071	50	4	32



CLAMPING NUTS FOR SEALING DISKS  
 FOR TOOLS WITH INTERNAL COOLANT  
 SPANNMUTTER FÜR DICHTSHEIBEN  
 FÜR DIE INNERE KÜHLUNG  
 GHIERE CON SEDE DISCO DI TENUTA PER UTENSILI  
 CON FISSAGGIO DI LUBRIFICAZIONE INTERNA  
 BAGUE AVEC D'ETANCHEITE POUR  
 LA LUBRIFICATION A L'INTERIEUR

CODE N.	D	L	ER
812-203089	30	22,5	16
812-203090	40	25,5	25
812-203091	50	28	32

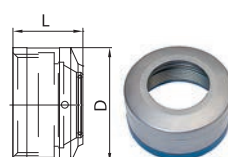

SEALING DISKS  
 DICHTSCHEIBEN  
 DISCHI DI TENUTA  
 DISQUES D'ETANCHEITE

CODE N.	D	L	d	RANGE	ER
DIS.16. ...	13	4	3÷10	0,5	16
DIS.25. ...	21	4	3÷16	0,5	25
DIS.32. ...	27	4	3÷20	0,5	32

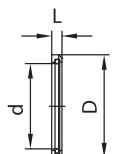

Example: DIS.16.06 >> Sealing disk Ø6÷5,5

DOUBLE CONTACT ER COLLET CHUCK  
 DOPPELKONTAKT AUFNAHMEN ER SPANNZANGENFUTTER  
 ЦАНГОВЫЙ ПАТРОН ER С ДВОЙНЫМ КОНТАКТОМ

MANDRINI PORTAPINZA A DOPPIO CONTATTO TIPO ER  
 MADRINS DOUBLE CONTACT PORTE-PINCE ER  
 ER双向夹头

**DIN69871 AD+B DOPPIO CONTATTO - DIN 6499**

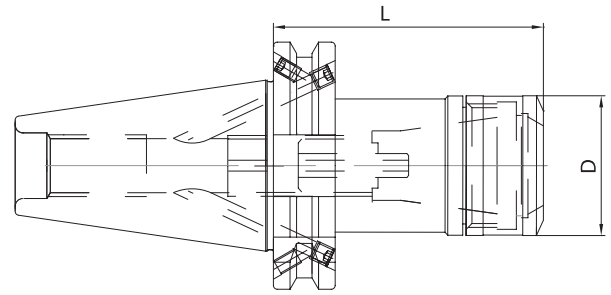

## DOUBLE CONTACT

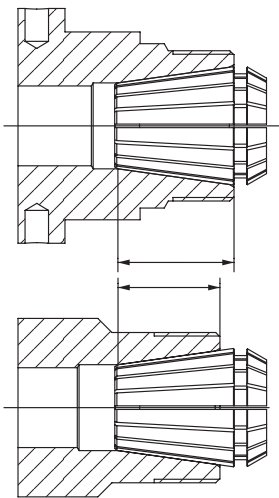

HIGH  
PRECISION  
LINE

STANDARD

	CODE N.	DESCRIPTION	ISO	L	D	ER	G2,5 30000
ISO40	214-37115	TC40H70ER16-HPDK	40	70	30	16	•
	214-37116	TC40H70ER25-HPDK	40	70	40	25	•
	214-37117	TC40H70ER32-HPDK	40	70	50	32	•
ISO 40	214-37118	TC40H100ER16-HPDK	40	100	30	16	•
	214-37119	TC40H100ER25-HPDK	40	100	40	25	•
	214-37120	TC40H100ER32-HPDK	40	100	50	32	•
ISO 50	214-37121	TC50H80ER16-HPDK	50	80	30	16	•
	214-37122	TC50H80ER25-HPDK	50	80	40	25	•
	214-37123	TC50H80ER32-HPDK	50	80	50	32	•
ISO 50	214-37124	TC50H100ER16-HPDK	50	100	30	16	•
	214-37125	TC50H100ER25-HPDK	50	100	40	25	•
	214-37126	TC50H100ER32-HPDK	50	100	50	32	•

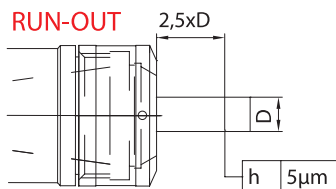

RUN-OUT

Accessories  
 Accessori  
 Zubehör  
 Accessoires  
 Принадлежности  
 零件



pag. 166 cat.



pag. 166 cat.

COLLETS ER TYPE  
 ER TYP SPANNZANGEN  
 НАБОРЫ ЦАНГ ER  
 PINZE TIPO ER  
 PINCES TYPE ER  
 ER 类型的夹头

CODE N.	D	L	ER
812-203085	30	18	16
812-203086	40	20,5	25
812-203087	50	23,5	32

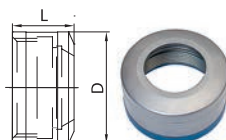

WRENCHES FOR NUT  
 SPANNSCHLÜSSEL FÜR SPANNMUTTER  
 КЛЮЧИ ДЛЯ СТАНДАРТНЫХ ГАЕК  
 CHIAVI PER GHIERA  
 CLES DE SERRAGE POUR ECROU  
 标准螺母用扳手

CODE N.	D	D1	ER
816-203069	30	3	16
816-203070	40	4	25
816-203071	50	4	32



CLAMPING NUTS FOR SEALING DISKS  
 FOR TOOLS WITH INTERNAL COOLANT  
 SPANNMUTTER FÜR DICHTSHEIBEN  
 FÜR DIE INNERE KÜHLUNG  
 GHIERE CON SEDE DISCO DI TENUTA PER UTENSILI  
 CON FISSAGGIO DI LUBRIFICAZIONE INTERNA  
 BAGUE AVEC D'ETANCHEITE POUR  
 LA LUBRIFICATION A L'INTERIEUR

CODE N.	D	L	ER
812-203089	30	22,5	16
812-203090	40	25,5	25
812-203091	50	28	32

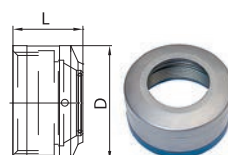

SEALING DISKS  
 DICHTSCHEIBEN  
 DISCHI DI TENUTA  
 DISQUES D'ETANCHEITE

CODE N.	D	L	d	RANGE	ER
DIS.16. ...	13	4	3÷10	0,5	16
DIS.25. ...	21	4	3÷16	0,5	25
DIS.32. ...	27	4	3÷20	0,5	32

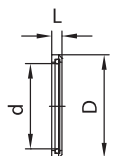

Example: DIS.16.06 >> Sealing disk Ø6÷5,5

ER COLLET CHUCK MANDRINI PORTAPINZA TIPO ER  
 SPANNZANGENFUTTER ER TYP MANDRINS A PINCES TYPE ER  
 ЦАНГОВЫЕ ПАТРОНЫ ER ER 弹簧夹头

DIN69871 AD+B - DIN 6499

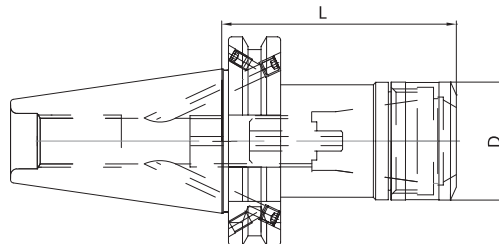
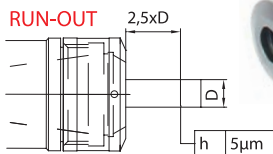
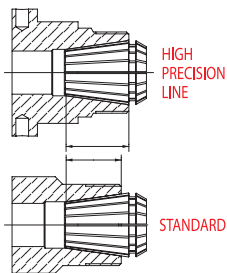

COLLETS ER TYPE PINZE TIPO ER  
 ER TYP SPANNZANGEN PINCES TYPE ER  
 НАБОРЫ ЦАНГ ER ER 类型的夹头

CODE N.	D	L	ER
812-203085	30	18	16
812-203086	40	20,5	25
812-203087	50	23,5	32

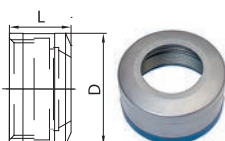

	CODE N.	DESCRIPTION	ISO	L	D	ER	G2,5 30000
ISO 40	214-91355	TC40H70ER16-HP	40	70	30	16	•
	214-91356	TC40H70ER25-HP	40	70	40	25	•
	214-91357	TC40H70ER32-HP	40	70	50	32	•
ISO 50	214-91358	TC50H70ER16-HP	50	70	30	16	•
	214-91366	TC50H70ER25-HP	50	70	40	25	•
	214-91359	TC50H70ER32-HP	50	70	50	32	•
ISO 40	214-91360	TC40H100ER16-HP	40	100	30	16	•
	214-91362	TC40H100ER25-HP	40	100	40	25	•
	214-91363	TC40H100ER32-HP	40	100	50	32	•
ISO 50	214-91364	TC50H100ER16-HP	50	100	30	16	•
	214-91367	TC50H100ER25-HP	50	100	40	25	•
	214-91365	TC50H100ER32-HP	50	100	50	32	•

WRENCHES FOR NUT CHIAVI PER GHIERA  
 SPANNSCHLÜSSEL FÜR SPANNMUTTER CLES DE SERRAGE POUR ECROU  
 КЛЮЧИ ДЛЯ СТАНДАРТНЫХ ГАЕК 标准螺母用扳手

CODE N.	D	D1	ER
816-203069	30	3	16
816-203070	40	4	25
816-203071	50	4	32



Accessories  
 Accessori  
 Zubehör  
 Accessoires  
 Принадлежности  
 零件



pag. 166 cat.



pag. 166 cat.

CLAMPING NUTS FOR SEALING DISKS GHIERE CON SEDE DISCO DI TENUTA PER UTENSILI  
 FOR TOOLS WITH INTERNAL COOLANT CON FISSAGGIO DI LUBRIFICAZIONE INTERNA  
 SPANNMUTTER FÜR DICHTSHEIBEN BAGUE AVEC D'ÉTANCHEITE POUR  
 FÜR DIE INNERE KÜHLUNG LA LUBRIFICATION À L'INTERIEUR

CODE N.	D	L	ER
812-203089	30	22,5	16
812-203090	40	25,5	25
812-203091	50	28	32

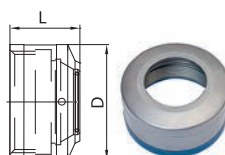

SEALING DISKS DISCHI DI TENUTA  
 DICHTSHEIBEN DISQUES D'ÉTANCHEITE

CODE N.	D	L	d	RANGE	ER
DIS.16. ...	13	4	3÷10	0,5	16
DIS.25. ...	21	4	3÷16	0,5	25
DIS.32. ...	27	4	3÷20	0,5	32

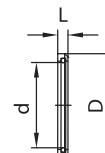

Example: DIS.16.06 >> Sealing disk Ø6÷5,5

COLLET CHUCK KITS KIT PORTAPINZE  
 SPANNFUTTERSATZ JEUX PORTE-PINCES  
 НАБОРЫ ОПРАВОК С ЦАНГАМИ 夹头变径套组套



**Kit Box:** 1 Collet chuck + 10 Collets  
**Cassetta Corredo:** 1 Portapinze + 10 pinze  
**Ausstattungskasten:** 1 Spannzangenfutter + 10 Spannzangen

**Boite d'équipement:** 1 Porte-pince + 10 pinces

**Набор:** из цангового патрона и цанг  
**套装:** 1个弹簧夹头刀柄 + 10个夹头

CODICE ORDINAZIONE ORDER CODE	COMPOSIZIONE COMPOSITION
KIT TC40 ER16 HP	N°1 TC40 H70 ER16 HP + N°10 COLLETS ER16 HP
KIT TC40 ER25 HP	N°1 TC40 H70 ER25 HP + N°10 COLLETS ER25 HP
KIT TC40 ER32 HP	N°1 TC40 H70 ER32 HP + N°10 COLLETS ER32 HP
KIT BT40 ER16 HP	N°1 BT40 H70 ER16 HP + N°10 COLLETS ER16 HP
KIT BT40 ER25 HP	N°1 BT40 H70 ER25 HP + N°10 COLLETS ER25 HP
KIT BT40 ER32 HP	N°1 BT40 H70 ER32 HP + N°10 COLLETS ER32 HP
KIT HSK63 ER16 HP	N°1 HSK63 AH75 ER16 HP + N°10 COLLETS ER16 HP
KIT HSK63 ER25 HP	N°1 HSK63 AH75 ER25 HP + N°10 COLLETS ER25 HP
KIT HSK63 ER32 HP	N°1 HSK63 AH75 ER32 HP + N°10 COLLETS ER32 HP

ER COLLET CHUCK    MANDRINI PORTAPINZA TIPO ER  
 SPANNZANGENFUTTER ER TYP    MANDRINS A PINCES TYPE ER  
 ЦАНГОВЫЕ ПАТРОНЫ ER    ER 弹簧夹头

**MAS BT AD+B - DIN 6499**

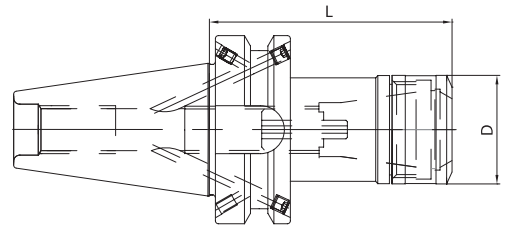
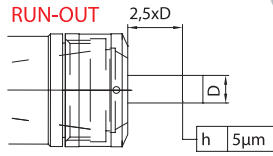
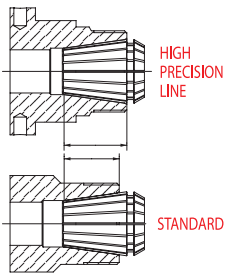

COLLETS ER TYPE    PINZE TIPO ER  
 ER TYP SPANNZANGEN    PINCES TYPE ER  
 НАБОРЫ ЦАНГ ER    ER 类型的夹头

CODE N.	D	L	ER
812-203085	30	18	16
812-203086	40	20,5	25
812-203087	50	23,5	32

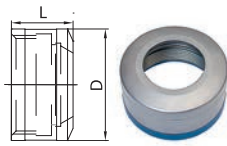

WRENCHES FOR NUT    CHIAVI PER GHIERA  
 SPANNSCHLÜSSEL FÜR SPANNMUTTER    CLES DE SERRAGE POUR ECROU  
 КЛЮЧИ ДЛЯ СТАНДАРТНЫХ ГАЕК    标准螺母用扳手

CODE N.	D	D1	ER
816-203069	30	3	16
816-203070	40	4	25
816-203071	50	4	32



	CODE N.	DESCRIPTION	ISO	L	D	ER	G2,5 30000
ISO 30	214-91473	BT30H70ER16-HP*	30	70	30	16	●
	214-91474	BT30H70ER25-HP*	30	70	40	25	●
	214-91475	BT30H70ER32-HP*	30	70	50	32	●
ISO 40	214-91462	BT40H70ER16-HP	40	70	30	16	●
	214-91463	BT40H70ER25-HP	40	70	40	25	●
	214-91464	BT40H70ER32-HP	40	70	50	32	●
ISO 50	214-91465	BT50H80ER16-HP	50	80	30	16	●
	214-91476	BT50H80ER25-HP	50	80	40	25	●
	214-91466	BT50H80ER32-HP	50	80	50	32	●
ISO 40	214-91467	BT40H100ER16-HP	40	100	30	16	●
	214-91469	BT40H100ER25-HP	40	100	40	25	●
	214-91470	BT40H100ER32-HP	40	100	50	32	●
ISO 50	214-91471	BT50H100ER16-HP	50	100	30	16	●
	214-91477	BT50H100ER25-HP	50	100	40	25	●
	214-91472	BT50H100ER32-HP	50	100	50	32	●

- \* BT30 only AD version
- \* BT30 solo versione AD
- \* BT30 nur AD Ausführung
- \* BT30 seulement Version AD
- \* BT30 только с AD исполнением
- \* BT30 只在 AD 版本下



Accessories  
 Accessori  
 Zubehör  
 Accessoires  
 Принадлежности  
 零件

CLAMPING NUTS FOR SEALING DISKS    GHIERE CON SEDE DISCO DI TENUTA PER UTENSILI  
 FOR TOOLS WITH INTERNAL COOLANT    CON FISSAGGIO DI LUBRIFICAZIONE INTERNA  
 SPANNMUTTER FÜR DICHTSHEIBEN    BAGUE AVEC D'ETANCHEITE POUR  
 FÜR DIE INNERE KÜHLUNG    LA LUBRIFICATION A L'INTERIEUR

CODE N.	D	L	ER
812-203089	30	22,5	16
812-203090	40	25,5	25
812-203091	50	28	32

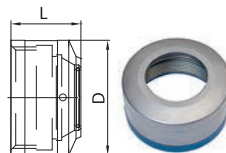

SEALING DISKS    DISCHI DI TENUTA  
 DICHTSHEIBEN    DISQUES D'ETANCHEITE

CODE N.	D	L	d	RANGE	ER
DIS.16. ...	13	4	3÷10	0,5	16
DIS.25. ...	21	4	3÷16	0,5	25
DIS.32. ...	27	4	3÷20	0,5	32

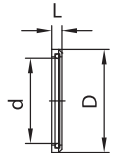

Example: DIS.16.06 >> Sealing disk Ø6÷5,5

COLLET CHUCK KITS    KIT PORTAPINZE  
 SPANNFUTTERSATZ    JEUX PORTE-PINCES  
 НАБОРЫ ОПРАВОК С ЦАНГАМИ    夹头变径套组套



- Kit Box:** 1 Collet chuck + 10 Collets
- Cassetta Corredo:** 1 Portapinze + 10 pinze
- Ausstattungskasten:** 1 Spannzangenfutter + 10 Spannzangen

**Boite d'équipement:** 1 Porte-pince + 10 pinces

**Набор:** из цангового патрона и цанг  
**套装:** 1个弹簧夹头刀柄 + 10个夹头

CODICE ORDINAZIONE ORDER CODE	COMPOSIZIONE COMPOSITION
KIT TC40 ER16 HP	N°1 TC40 H70 ER16 HP + N°10 COLLETS ER16 HP
KIT TC40 ER25 HP	N°1 TC40 H70 ER25 HP + N°10 COLLETS ER25 HP
KIT TC40 ER32 HP	N°1 TC40 H70 ER32 HP + N°10 COLLETS ER32 HP
KIT BT40 ER16 HP	N°1 BT40 H70 ER16 HP + N°10 COLLETS ER16 HP
KIT BT40 ER25 HP	N°1 BT40 H70 ER25 HP + N°10 COLLETS ER25 HP
KIT BT40 ER32 HP	N°1 BT40 H70 ER32 HP + N°10 COLLETS ER32 HP
KIT HSK63 ER16 HP	N°1 HSK63 AH75 ER16 HP + N°10 COLLETS ER16 HP
KIT HSK63 ER25 HP	N°1 HSK63 AH75 ER25 HP + N°10 COLLETS ER25 HP
KIT HSK63 ER32 HP	N°1 HSK63 AH75 ER32 HP + N°10 COLLETS ER32 HP

ER COLLET CHUCK MANDRINI PORTAPINZA TIPO ER  
 SPANNZANGENFUTTER ER TYP MANDRINS A PINCES TYPE ER  
 ЦАНГОВЫЕ ПАТРОНЫ ER ER 弹簧夹头

DIN69893 HSKA - DIN 6499

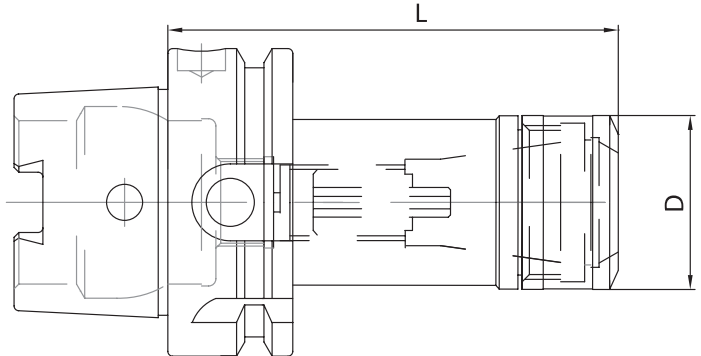
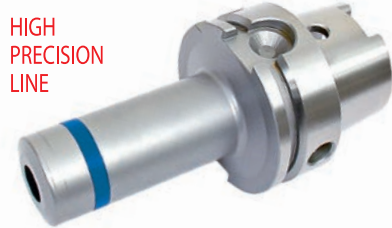
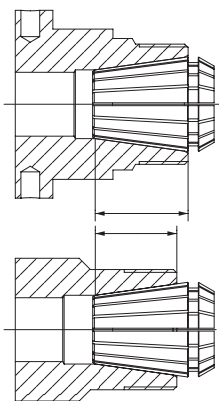

STANDARD

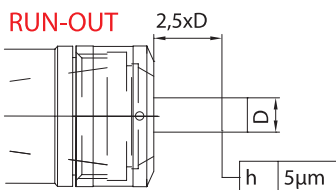

CODE N.	DESCRIPTION	HSK	L	D	ER	G2,5 30000
214-91747	HSK63AH75ER16-HP	63	75	30	16	•
214-91748	HSK63AH75ER25-HP	63	75	40	25	•
214-91749	HSK63AH75ER32-HP	63	75	50	32	•
214-91738	HSK63AH100ER16-HP	63	100	30	16	•
214-91739	HSK63AH100ER25-HP	63	100	40	25	•
214-91740	HSK63AH100ER32-HP	63	100	50	32	•
214-91742	HSK63AH160ER16-HP	63	160	30	16	•
214-91743	HSK63AH160ER25-HP	63	160	40	25	•
214-91744	HSK63AH160ER32-HP	63	160	50	32	•
214-91741	HSK100AH100ER32-HP	100	100	50	32	•
214-91750	HSK100AH160ER25-HP	100	160	40	25	•
214-91746	HSK100AH160ER32-HP	100	160	50	32	•

Accessories  
 Accessori  
 Zubehör  
 Accessoires  
 Принадлежности  
 零件

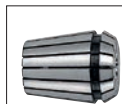

pag. 166 cat.



pag. 166 cat.

WRENCHES FOR NUT CHIAVI PER GHIERA  
 SPANNSCHLÜSSEL FÜR SPANNMUTTER CLES DE SERRAGE POUR ECROU  
 КЛЮЧИ ДЛЯ СТАНДАРТНЫХ ГАЕК 标准螺母用扳手

CODE N.	D	D1	ER
816-203069	30	3	16
816-203070	40	4	25
816-203071	50	4	32



COLLETS ER TYPE PINZE TIPO ER  
 ER TYP SPANNZANGEN PINCES TYPE ER  
 НАБОРЫ ЦАНГ ER ER 类型的夹头

CODE N.	D	L	ER
812-203085	30	18	16
812-203086	40	20,5	25
812-203087	50	23,5	32

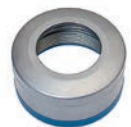
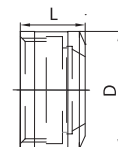

COLLET CHUCK KITS KIT PORTAPINZE  
 SPANNFUTTERSATZ JEUX PORTE-PINCES  
 НАБОРЫ ОПРАВК С ЦАНГАМИ 夹头变径套组套



**Kit Box:** 1 Collet chuck + 10 Collets  
**Cassetta Corredo:** 1 Portapinze + 10 pinze  
**Ausstattungskasten:** 1 Spannzangenfutter + 10 Spannzangen

**Boite d'équipement:** 1 Porte-pince + 10 pinces

**Набор:** из цангового патрона и цанг  
**套装:** 1个弹簧夹头刀柄 + 10个夹头

CODICE ORDINAZIONE ORDER CODE	COMPOSIZIONE COMPOSITION
KIT TC40 ER16 HP	N°1 TC40 H70 ER16 HP + N°10 COLLETS ER16 HP
KIT TC40 ER25 HP	N°1 TC40 H70 ER25 HP + N°10 COLLETS ER25 HP
KIT TC40 ER32 HP	N°1 TC40 H70 ER32 HP + N°10 COLLETS ER32 HP
KIT BT40 ER16 HP	N°1 BT40 H70 ER16 HP + N°10 COLLETS ER16 HP
KIT BT40 ER25 HP	N°1 BT40 H70 ER25 HP + N°10 COLLETS ER25 HP
KIT BT40 ER32 HP	N°1 BT40 H70 ER32 HP + N°10 COLLETS ER32 HP
KIT HSK63 ER16 HP	N°1 HSK63 AH75 ER16 HP + N°10 COLLETS ER16 HP
KIT HSK63 ER25 HP	N°1 HSK63 AH75 ER25 HP + N°10 COLLETS ER25 HP
KIT HSK63 ER32 HP	N°1 HSK63 AH75 ER32 HP + N°10 COLLETS ER32 HP

# KINTEK®



**HEAD OFFICE**  
KINTEK S.R.L. - MAPPANO - TORINO - ITALY



**NEW PRODUCTION PLANT**  
A.M.T S.R.L. - CASELLE T.SE - TORINO - ITALY



**MAIN PRODUCTION PLANT**  
KINTEK TOOLING KFT - BEKESCSABA - HUNGARY

## **KINTEK s.r.l.**

Via Goretta 88/G - 10079 MAPPANO - (TO) - ITALY  
Tel. +39 011 99 68 065 - Fax +39 011 99 65 662  
e-mail: [info@kintek.it](mailto:info@kintek.it)  
<http://www.kintek.it>